

Note that all unique customer requirements (i.e tolerance) need to be verified thru Alfa Laval.

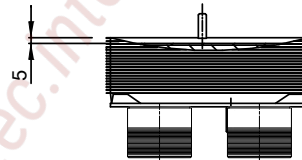
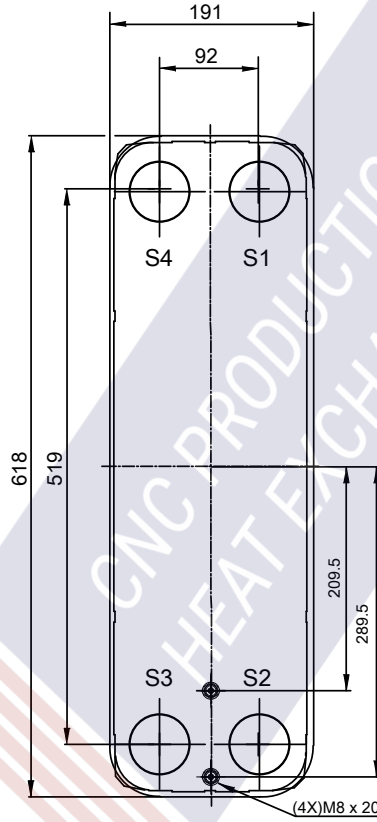
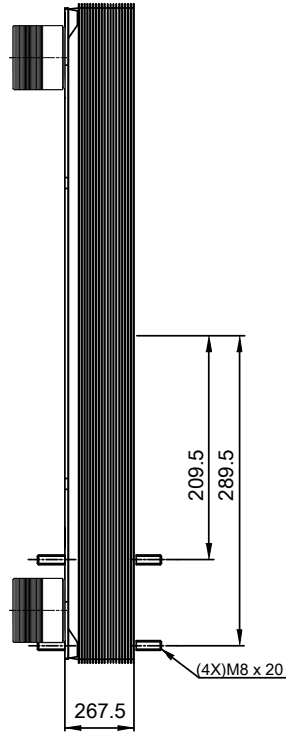
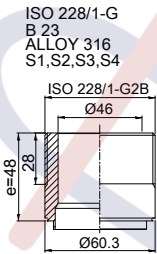

HEATING SURFACE m²
 NETWEIGHT 50.5 kg
 OPERATING WEIGHT kg
 PLATE MATERIAL ALLOY 316
 PLATE GROUPING 1*44H/1*45H

T1 T2 T3 T4 locations on back side correspond to S1 S2 S3 S4 on front side

ALL DIMENSIONS IN MILLIMETERS

| SIDE | MEDIA | INLET | TEMP. °C | OUTLET | TEMP. °C | FLOW RATE | PRESSURE DROP | LIQUID VOL. |
|------|-------|-------|----------|--------|----------|-----------|---------------|----------------------|
| 1 | Water | S1 | °C | S2 | °C | kg/h | kPa | 11.3 dm ³ |
| 2 | Water | S3 | °C | S4 | °C | kg/h | kPa | 11.0 dm ³ |

PRESSURE VESSEL APPROVAL PED

AlfaNova 76-90H (3287050296)

www.alfalaval.com

CUSTOMER NAME / REF. NO.

TOTAL LENGTH 331 mm
 TOTAL WIDTH 191 mm
 TOTAL HEIGHT 618 mm

COMPANY / REF.
 Aptec production s.r.o.
 GPHE to Linz



3/14/2023
 REV 0